

257.83 (b) (2)	REPORT OF ANNUAL INSPECTION OF CCR SURFACE IMPOUNDMENT		
	FACILITY NAME: Plant Wansley Ash Pond		
	OWNER/OPERATOR OF FACILITY: Georgia Power Company		
	INSPECTION DATE: November 4, 2024		
	INSPECTING ENGINEER: J. Marlon Thomas, P.E. (Georgia P.E. License #040073)		
(i)	ANY CHANGES IN GEOMETRY OF THE IMPOUNDING STRUCTURE SINCE THE PREVIOUS ANNUAL INSPECTION?		No
	(IF YES, DESCRIBE):		
(ii)	LOCATION AND TYPE OF EXISTING INSTRUMENTATION		See Attached Plan
(ii)	MAXIMUM RECORDED READING OF EACH INSTRUMENT SINCE PREVIOUS ANNUAL INSPECTION		See Attached Table
(iii)	APPROXIMATE MINIMUM, MAXIMUM AND PRESENT DEPTH AND ELEVATION OF THE IMPOUNDED WATER SINCE PREVIOUS ANNUAL INSPECTION		
	MIN. DEPTH: 0 ft	MAX. DEPTH: 50 ft	PRESENT DEPTH: Up to 48 ft
	MIN. ELEVATION: 783 ft	MAX. ELEVATION: 785 ft	PRESENT ELEVATION: 783 ft
(iii)	APPROXIMATE MINIMUM, MAXIMUM AND PRESENT DEPTH AND ELEVATION OF CCR SINCE PREVIOUS ANNUAL INSPECTION		
	MIN. DEPTH: 0 ft	MAX. DEPTH: 102 ft	PRESENT DEPTH: Up to 102 ft
	MIN. ELEVATION: 705 ft	MAX. ELEVATION: 815 ft	PRESENT ELEVATION: Up to 812 ft ⁽¹⁾
(iv)	APPROXIMATE STORAGE CAPACITY OF IMPOUNDING STRUCTURE AT TIME OF INSPECTION		29,615,000 yd ³ ⁽²⁾
(v)	APPROXIMATE VOLUME OF IMPOUNDED WATER AND CCR AT TIME OF INSPECTION		WATER: 9,562,000 yd ³ CCR: 15,650,000 yd ³
(vi)	ANY APPEARANCE OF AN ACTUAL OR POTENTIAL STRUCTURAL WEAKNESS OF THE CCR UNIT, IN ADDITION TO ANY EXISTING CONDITIONS THAT ARE DISRUPTING OR HAVE THE POTENTIAL TO DISRUPT THE OPERATION AND SAFETY OF THE CCR UNIT AND APPURTENANT STRUCTURES?		No
	(IF YES, DESCRIBE):		
(vii)	ANY OTHER CHANGE(S) WHICH MAY HAVE AFFECTED THE STABILITY OR OPERATION SINCE THE PREVIOUS ANNUAL INSPECTION?		No
	(IF YES, DESCRIBE):		

- (1) Present elevation and depth represent the general maximum grade of gypsum storage areas at the time of inspection. Material may be temporarily stockpiled to higher elevations at other times.
- (2) Approximate storage capacity of impounding structure is estimated as the total storage volume of the pond up to the dam crest elevation of 805 feet.



**MAXIMUM RECORDED READINGS OF INSTRUMENTATION
PLANT WANSLEY ASH POND**

PIEZOMETER NUMBER ⁽¹⁾	LOCATION	MAXIMUM RECORDED READING ⁽²⁾
BB	N 33° 24.939', W 85° 02.507'	EL 781
DD	N 33° 25.063', W 85° 02.656'	EL 783

(1) Piezometers Installed on Separator Dike Between Ash Pond and Storage Pond

(2) Maximum recorded reading since last annual inspection; rounded to the nearest foot.

290013

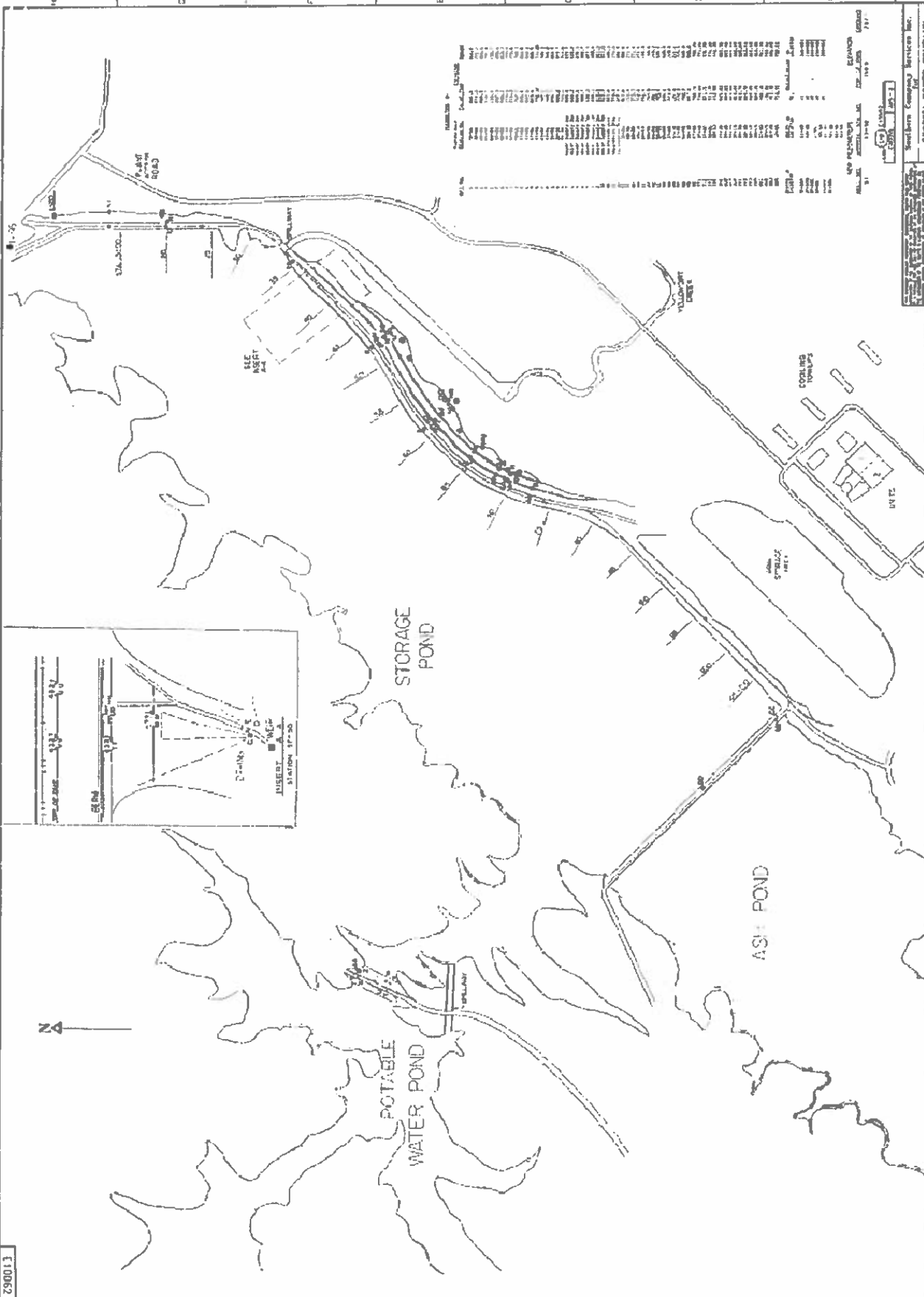

INSTRUMENT NO.	DESCRIPTION	ELEVATION	DATE	STATUS
1	ASSET	100.00	10/10/88	OK
2	VALVE	100.00	10/10/88	OK
3	ASSET	100.00	10/10/88	OK
4	VALVE	100.00	10/10/88	OK
5	ASSET	100.00	10/10/88	OK
6	VALVE	100.00	10/10/88	OK
7	ASSET	100.00	10/10/88	OK
8	VALVE	100.00	10/10/88	OK
9	ASSET	100.00	10/10/88	OK
10	VALVE	100.00	10/10/88	OK
11	ASSET	100.00	10/10/88	OK
12	VALVE	100.00	10/10/88	OK
13	ASSET	100.00	10/10/88	OK
14	VALVE	100.00	10/10/88	OK
15	ASSET	100.00	10/10/88	OK
16	VALVE	100.00	10/10/88	OK
17	ASSET	100.00	10/10/88	OK
18	VALVE	100.00	10/10/88	OK
19	ASSET	100.00	10/10/88	OK
20	VALVE	100.00	10/10/88	OK
21	ASSET	100.00	10/10/88	OK
22	VALVE	100.00	10/10/88	OK
23	ASSET	100.00	10/10/88	OK
24	VALVE	100.00	10/10/88	OK
25	ASSET	100.00	10/10/88	OK
26	VALVE	100.00	10/10/88	OK
27	ASSET	100.00	10/10/88	OK
28	VALVE	100.00	10/10/88	OK
29	ASSET	100.00	10/10/88	OK
30	VALVE	100.00	10/10/88	OK
31	ASSET	100.00	10/10/88	OK
32	VALVE	100.00	10/10/88	OK
33	ASSET	100.00	10/10/88	OK
34	VALVE	100.00	10/10/88	OK
35	ASSET	100.00	10/10/88	OK
36	VALVE	100.00	10/10/88	OK
37	ASSET	100.00	10/10/88	OK
38	VALVE	100.00	10/10/88	OK
39	ASSET	100.00	10/10/88	OK
40	VALVE	100.00	10/10/88	OK
41	ASSET	100.00	10/10/88	OK
42	VALVE	100.00	10/10/88	OK
43	ASSET	100.00	10/10/88	OK
44	VALVE	100.00	10/10/88	OK
45	ASSET	100.00	10/10/88	OK
46	VALVE	100.00	10/10/88	OK
47	ASSET	100.00	10/10/88	OK
48	VALVE	100.00	10/10/88	OK
49	ASSET	100.00	10/10/88	OK
50	VALVE	100.00	10/10/88	OK
51	ASSET	100.00	10/10/88	OK
52	VALVE	100.00	10/10/88	OK
53	ASSET	100.00	10/10/88	OK
54	VALVE	100.00	10/10/88	OK
55	ASSET	100.00	10/10/88	OK
56	VALVE	100.00	10/10/88	OK
57	ASSET	100.00	10/10/88	OK
58	VALVE	100.00	10/10/88	OK
59	ASSET	100.00	10/10/88	OK
60	VALVE	100.00	10/10/88	OK
61	ASSET	100.00	10/10/88	OK
62	VALVE	100.00	10/10/88	OK
63	ASSET	100.00	10/10/88	OK
64	VALVE	100.00	10/10/88	OK
65	ASSET	100.00	10/10/88	OK
66	VALVE	100.00	10/10/88	OK
67	ASSET	100.00	10/10/88	OK
68	VALVE	100.00	10/10/88	OK
69	ASSET	100.00	10/10/88	OK
70	VALVE	100.00	10/10/88	OK
71	ASSET	100.00	10/10/88	OK
72	VALVE	100.00	10/10/88	OK
73	ASSET	100.00	10/10/88	OK
74	VALVE	100.00	10/10/88	OK
75	ASSET	100.00	10/10/88	OK
76	VALVE	100.00	10/10/88	OK
77	ASSET	100.00	10/10/88	OK
78	VALVE	100.00	10/10/88	OK
79	ASSET	100.00	10/10/88	OK
80	VALVE	100.00	10/10/88	OK
81	ASSET	100.00	10/10/88	OK
82	VALVE	100.00	10/10/88	OK
83	ASSET	100.00	10/10/88	OK
84	VALVE	100.00	10/10/88	OK
85	ASSET	100.00	10/10/88	OK
86	VALVE	100.00	10/10/88	OK
87	ASSET	100.00	10/10/88	OK
88	VALVE	100.00	10/10/88	OK
89	ASSET	100.00	10/10/88	OK
90	VALVE	100.00	10/10/88	OK
91	ASSET	100.00	10/10/88	OK
92	VALVE	100.00	10/10/88	OK
93	ASSET	100.00	10/10/88	OK
94	VALVE	100.00	10/10/88	OK
95	ASSET	100.00	10/10/88	OK
96	VALVE	100.00	10/10/88	OK
97	ASSET	100.00	10/10/88	OK
98	VALVE	100.00	10/10/88	OK
99	ASSET	100.00	10/10/88	OK
100	VALVE	100.00	10/10/88	OK

Southern Company Services Inc.
 GEORGIA POWER COMPANY
 PLANT WANSLEY
 SURVEILLANCE
 INSTRUMENTATION
 LOCATION

DATE: 10/10/88
 DRAWN BY: [Name]
 CHECKED BY: [Name]